

**NOTE - ALTERNATE TRIM FINISH FIXINGS**

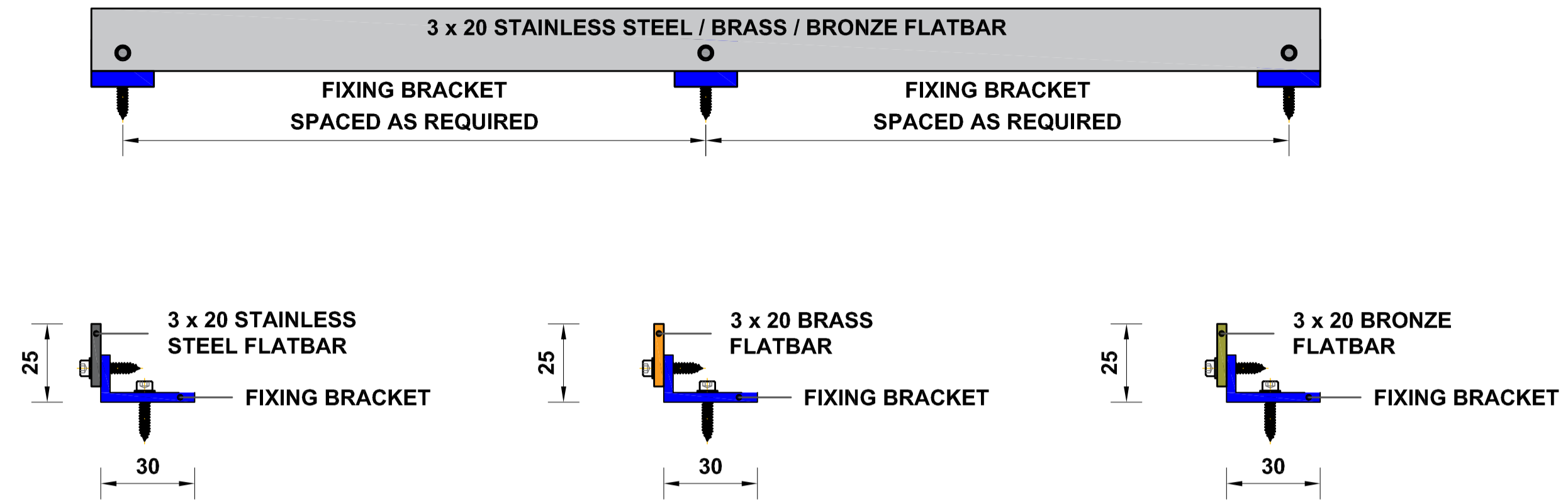

**Notes:**

LAZENBY Concrete sub floor :

Reinforcement(Anti-crack only):

A 252 Mesh on spacers to centre of slab with min cover of 35mm

8 mm straights where required

**IF SUB FLOOR INSTALLED BY OTHERS (CONCRETE or SCREED) JOINT DETAILS ARE TO BE INSTALLED TO MATCH JOINTS REQUIRED IN TERRAZZO for ANTI-CRACK**

If Terrazzo needs to be installed at a depth less than 25mm a bespoke system can be designed by LAZENBY to suit.

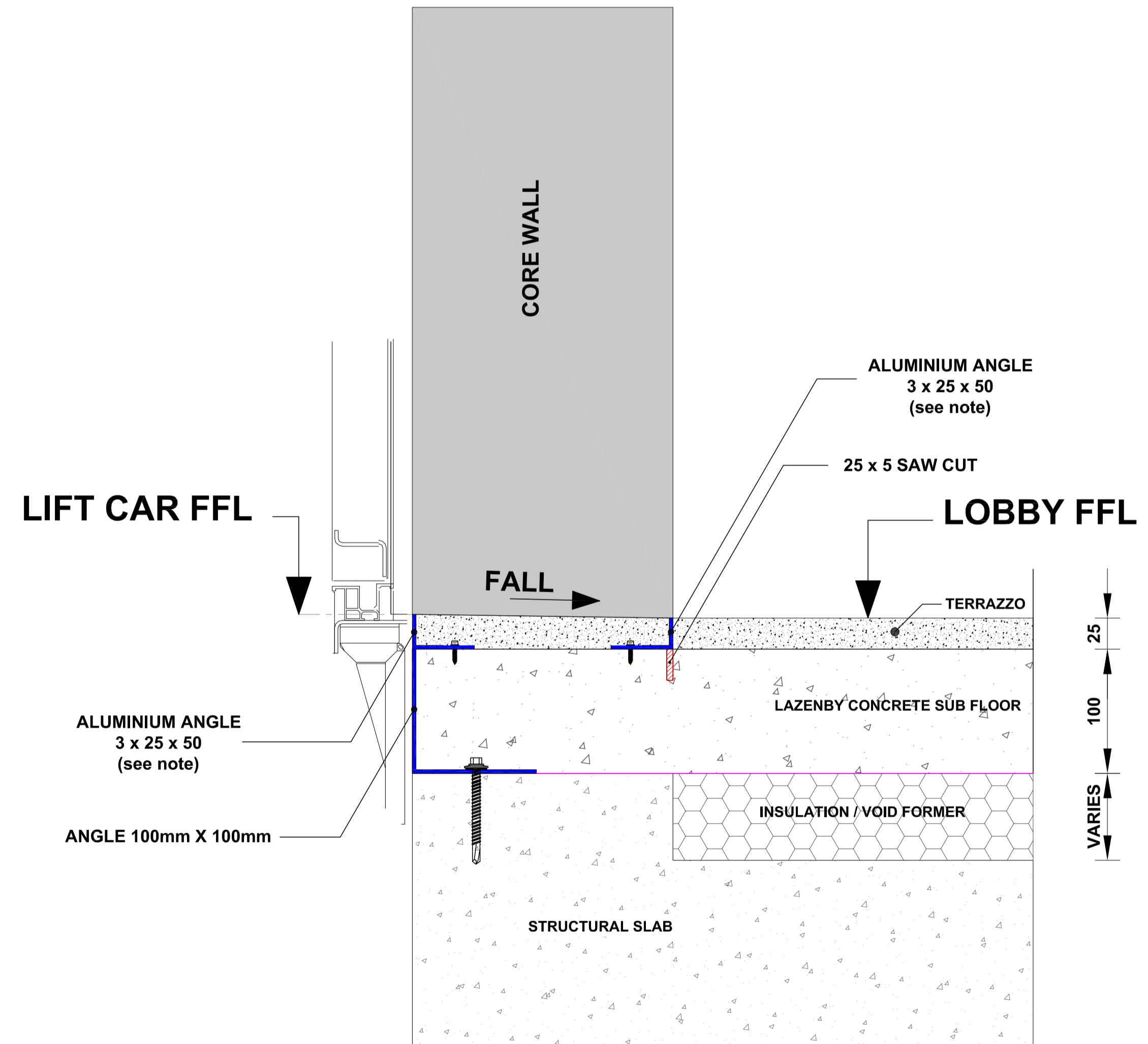
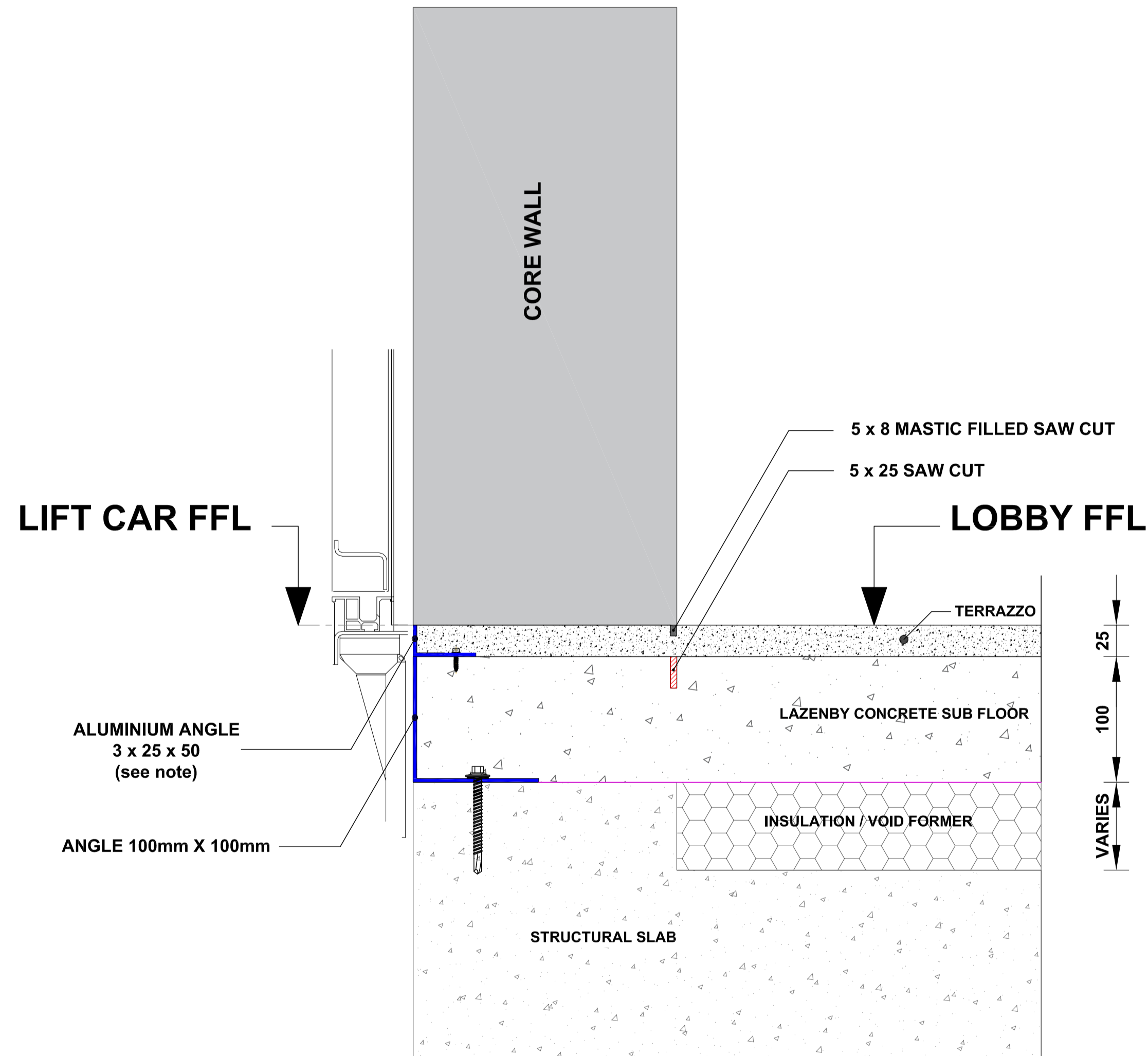

Unit 1,  
Victoria Road Industrial Estate,  
North Acton,  
London W3 6UU  
info@lazenby.co.uk

**lazenby**  
iconic polished concrete  
flooring and surfaces

<https://www.lazenby.co.uk>

Project							
Description		Date	Revision				
Title		Sheet Size	Stage	Purpose			
Terrazzo Lift Threshold Detail		A1					
Date		Scale: NOT TO SCALE					
Project	Sub Project	Originator	Zone	Level	Type	Role	Number